

# LogiLink®

## Water Leakage Detector

Art. No.: SC0105



The Water Leakage Detector finds leaks before damage occurs. Place under washing machine, water heater, dishwasher or sink, alarm will set off once leakage is detected. Prevent further catastrophe to home/office.

### Features:

- » Works on both hard and soft surfaces, such as carpet, floor etc. When water cause the two sensing probes to be short-circuit, the alarm will sound off
- » Can be use under washing machine, water heater, dishwasher, toilet sink, humidifier, ice maker, pipes close to outdoor taps
- » 85dB alarm sound, making sure people at home will hear and respond to the leakage
- » Compact size
- » IP65 protection from water jets

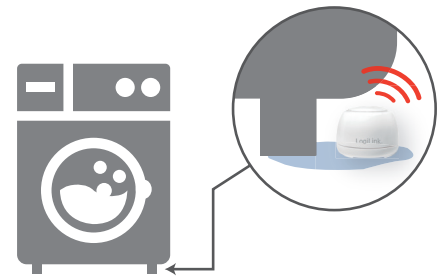

Place under washing machine.  
Activate alarm when water leakage is detected!

### Specification:

Power Source	LR44 DC1.5V button batteries x3
Standby Current	<5uA
Alarm Sensitivity	<2MΩ
Alarm Current	<45mA
Alarm Volume	>85dB(A) @ 1m
Waterproof	IP65
Humidity Range	<80% R.H.
Temperature Range	-10°C ~ 40°C
Sound Pattern	Quick beep
Dimension	Ø45mm x 33.3mm
Weight	20g (without batteries)

Best Connectivity



RoHS  
compliant



\* The specifications and pictures are subject to change without notice.  
\*All trade names referenced are the registered namework of their respective owners.



SC0105



Made in China

# LogiLink®

## Water Leakage Detector

Art. No.: SC0105



### Package Contents:

- » 1 x Water Leakage Detector
- » 3 x LR44 DC1.5V button batteries
- » 1 x User Manual

### Package Informations:

- » Packing Dimension: 60 x 60 x 50mm
- » Packing Weight: kg
- » Carton Dimension: mm
- » Carton Q'ty: pcs
- » Carton Weight: kg

### Warning

\*This is a water detector only, it provides early warning, but does not shut off the water flow.



SC0105



Made in China



RoHS  
compliant



\* The specifications and pictures are subject to change without notice.  
\*All trade names referenced are the registered namework of their respective owners.

Best Connectivity